

MegaSPAN

Composite Floor System

TYP-001

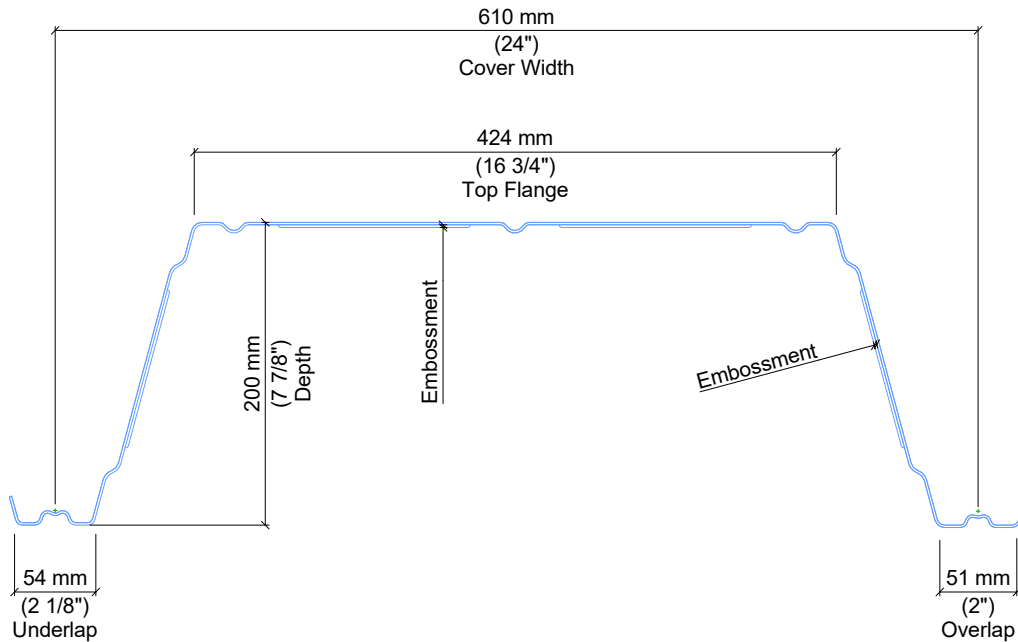

MEGASPAN PROFILE

REVISION NO.

1

DRAWN BY

HL

DATE

JAN 01, 2021

SCALE

1 : 5



8 ABACUS RD,
BRAMPTON, ONTARIO
TEL: (289) 588-0936 FAX: (905) 482 1920
contact@cpt-group.ca sales@cpt-group.ca

This drawing is intended as an aid to the design professional and should not be used to replace the judgement of a qualified engineer or architect. Canadian Panel Tech Limited makes no warranties, express or implied, for variations from such drawings in actual construction and does not obviate the need to determine the suitability for a given situation. Canadian Panel Tech Limited assumes no responsibility for any errors that may appear in this drawing. Please visit www.cpt-group.ca for more information.

MegaSPAN

Composite Floor System

TYP-002

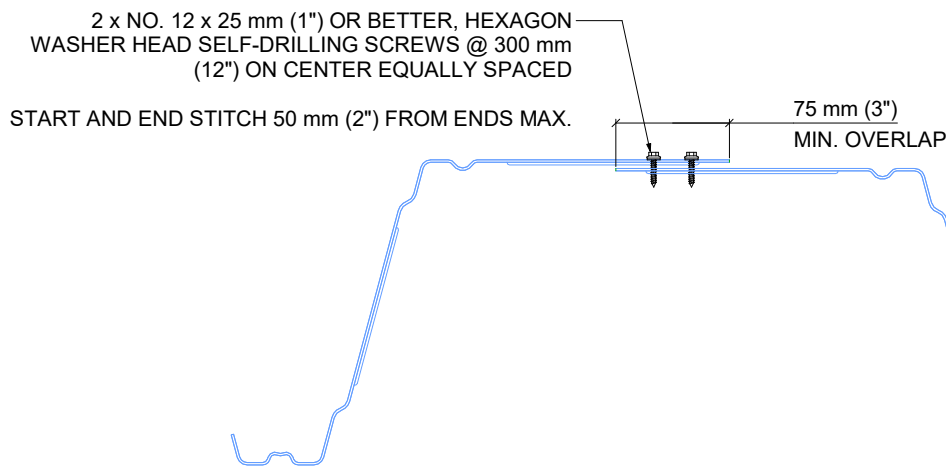

STITCH DETAIL

REVISION NO.

1

DRAWN BY

HL

DATE

JAN 01, 2021

SCALE

1 : 5



8 ABACUS RD,
BRAMPTON, ONTARIO
TEL: (289) 588-0936 FAX: (905) 482 1920
contact@cpt-group.ca sales@cpt-group.ca

This drawing is intended as an aid to the design professional and should not be used to replace the judgement of a qualified engineer or architect. Canadian Panel Tech Limited makes no warranties, express or implied, for variations from such drawings in actual construction and does not obviate the need to determine the suitability for a given situation. Canadian Panel Tech Limited assumes no responsibility for any errors that may appear in this drawing. Please visit www.cpt-group.ca for more information.

MegaSPAN

Composite Floor System

TYP-003

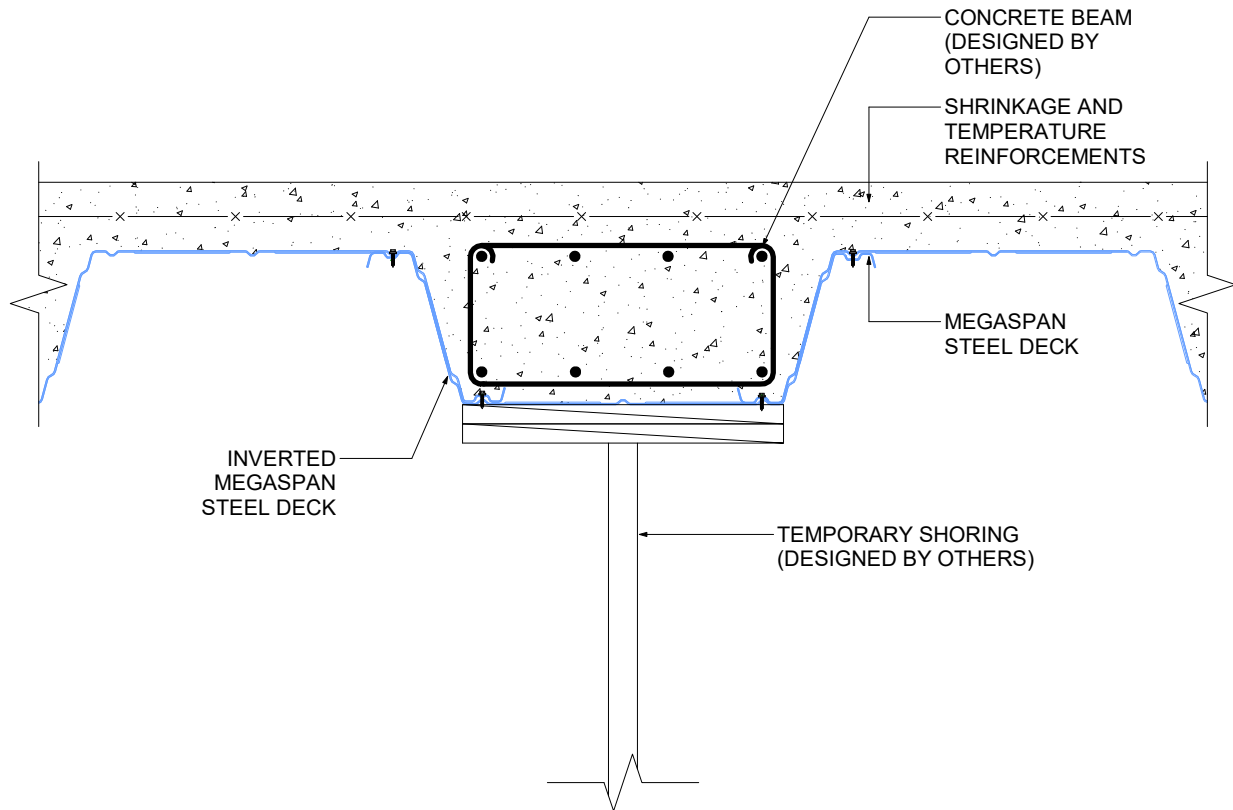

INVERTED DECK DETAIL

REVISION NO.

1

DRAWN BY

HL

DATE

JAN 01, 2021

SCALE

1 : 10



8 ABACUS RD,
BRAMPTON, ONTARIO
TEL: (289) 588-0936 FAX: (905) 482 1920
contact@cpt-group.ca sales@cpt-group.ca

This drawing is intended as an aid to the design professional and should not be used to replace the judgement of a qualified engineer or architect. Canadian Panel Tech Limited makes no warranties, express or implied, for variations from such drawings in actual construction and does not obviate the need to determine the suitability for a given situation. Canadian Panel Tech Limited assumes no responsibility for any errors that may appear in this drawing. Please visit www.cpt-group.ca for more information.